



Cherokee Lane Elementary School Schematic Design Presentation

Project Planning Committee Meeting

June 04, 2019



Meeting Agenda

- **Welcome and Introductions**
- **Review the Final Floor Plan Revision**
- **Review Square Footage Comparison**

Site Plan



OVERALL SITE PLAN

1" = 60'-0"

PRINCE GEORGE'S COUNTY PUBLIC SCHOOLS CHEROKEE LANE ELEMENTARY SCHOOL



ENLARGED SITE PLAN
 1" = 30'-0"

PRINCE GEORGE'S COUNTY PUBLIC SCHOOLS CHEROKEE LANE ELEMENTARY SCHOOL

Floor Plans

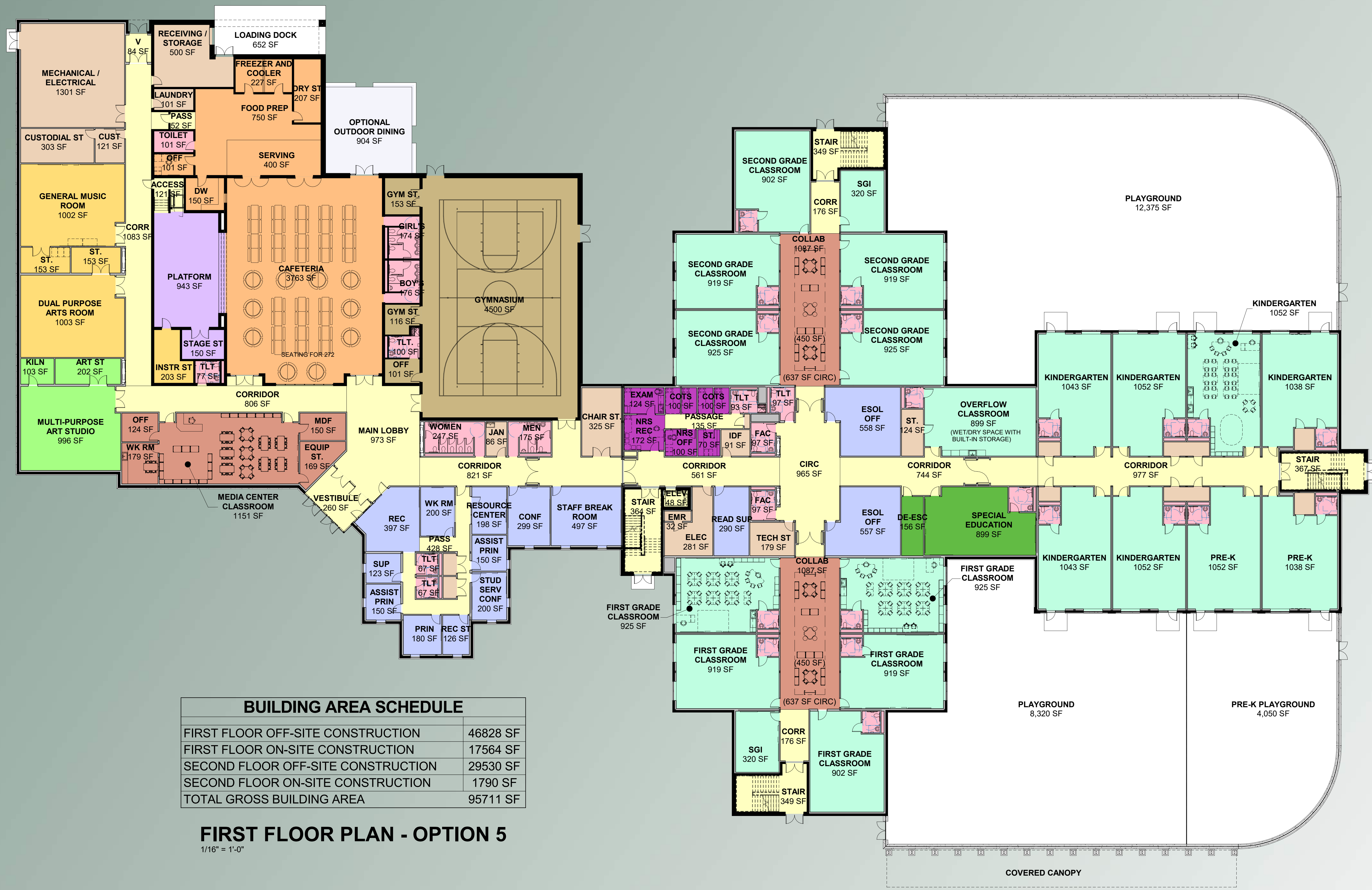

BUILDING AREA SCHEDULE	
FIRST FLOOR OFF-SITE CONSTRUCTION	46828 SF
FIRST FLOOR ON-SITE CONSTRUCTION	17564 SF
SECOND FLOOR OFF-SITE CONSTRUCTION	29530 SF
SECOND FLOOR ON-SITE CONSTRUCTION	1790 SF
TOTAL GROSS BUILDING AREA	95711 SF

FIRST FLOOR PLAN - OPTION 5
1/16" = 1'-0"

PRINCE GEORGE'S COUNTY PUBLIC SCHOOLS CHEROKEE LANE ELEMENTARY SCHOOL

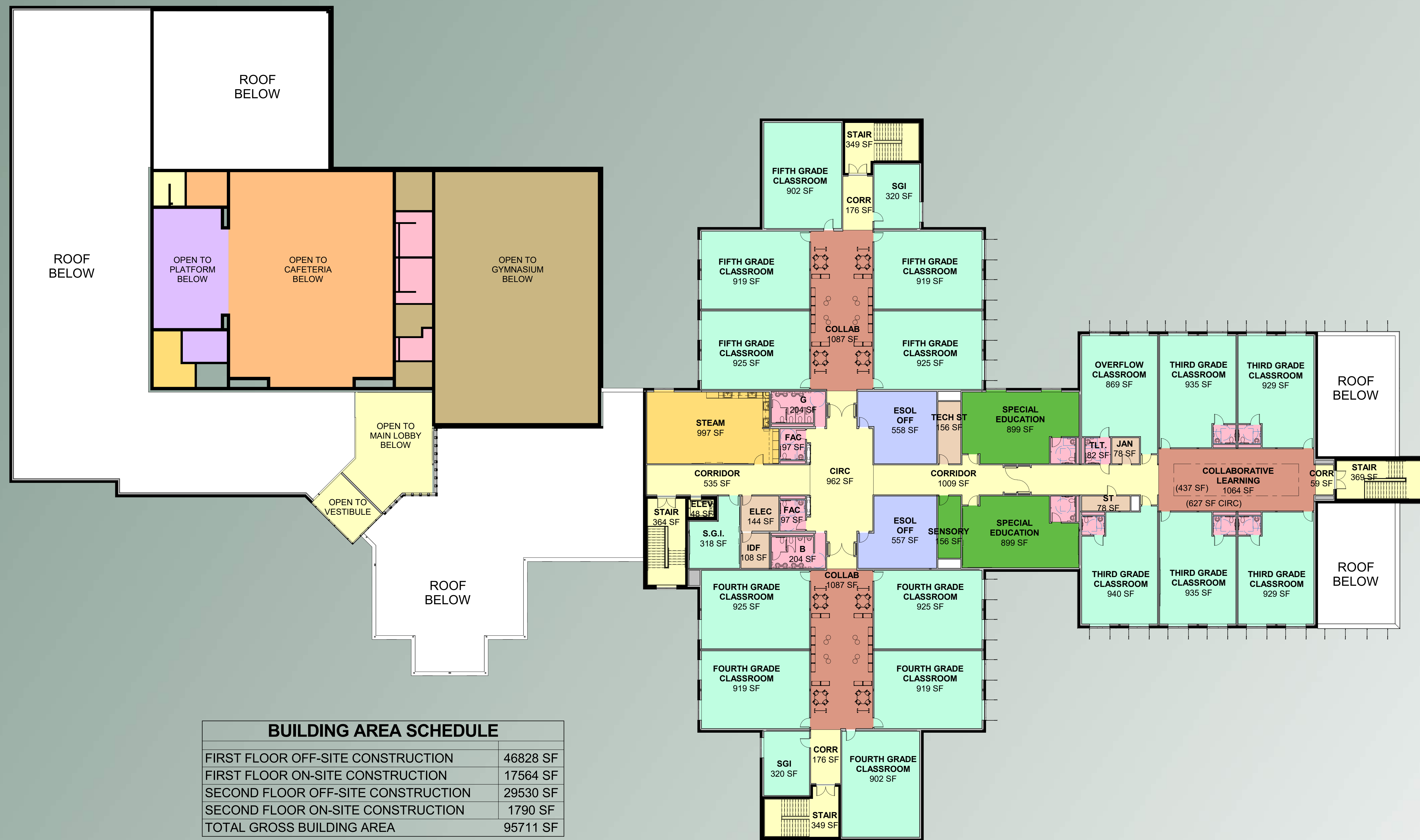

BUILDING AREA SCHEDULE	
FIRST FLOOR OFF-SITE CONSTRUCTION	46828 SF
FIRST FLOOR ON-SITE CONSTRUCTION	17564 SF
SECOND FLOOR OFF-SITE CONSTRUCTION	29530 SF
SECOND FLOOR ON-SITE CONSTRUCTION	1790 SF
TOTAL GROSS BUILDING AREA	95711 SF

SECOND FLOOR PLAN - OPTION 5
 1/16" = 1'-0"

PRINCE GEORGE'S COUNTY PUBLIC SCHOOLS CHEROKEE LANE ELEMENTARY SCHOOL



ENLARGED FIRST FLOOR PLAN

3/32" = 1'-0"

PRINCE GEORGE'S COUNTY PUBLIC SCHOOLS CHEROKEE LANE ELEMENTARY SCHOOL



ENLARGED FIRST FLOOR PLAN - ACADEMIC WING

3/32" = 1'-0"

PRINCE GEORGE'S COUNTY PUBLIC SCHOOLS

CHEROKEE LANE ELEMENTARY SCHOOL



ENLARGED SECOND FLOOR PLAN - ACADEMIC WING
3/32" = 1'-0"

Program/ Design Comparison

Cherokee Lane Elementary School - Square Foot Analysis



Academic Core Area

Ed Spec Net SF	Option 5 Net SF	Option 5 Delta	Proposed Room Use
0		0	Collaborative Learning
0		0	Collaborative Learning
0		0	Collaborative Learning
0		0	Collaborative Learning
0		0	Collaborative Learning
900	902	-2	Fifth Grade Classroom
900	919	-19	Fifth Grade Classroom
900	919	-19	Fifth Grade Classroom
900	925	-25	Fifth Grade Classroom
900	925	-25	Fifth Grade Classroom
950	902	48	First Grade Classroom
950	919	31	First Grade Classroom
950	919	31	First Grade Classroom
950	925	25	First Grade Classroom
950	925	25	First Grade Classroom
900	902	-2	Fourth Grade Classroom
900	919	-19	Fourth Grade Classroom
900	919	-19	Fourth Grade Classroom
900	925	-25	Fourth Grade Classroom
900	925	-25	Fourth Grade Classroom
1,100	1,043	57	Kindergarten
1,100	1,043	57	Kindergarten
1,100	1,052	48	Kindergarten
1,100	1,052	48	Kindergarten
1,100	1,052	48	Kindergarten
1,100	1,038	62	Kindergarten
1,100	1,052	48	Pre-K
1,100	1,038	62	Pre-K

Space should be added to Ed Spec
 Ed Spec SF should be increased
 Ed Spec SF should be decreased
 Provided SF is less than Ed Spec
 Provided SF is greater than Ed Spec
 Space is missing from design
 Space should be removed from Ed Spec
 Proposed Ed Spec Square Foot Total per Program Function

250	320	-70	S.G.I.
250	320	-70	S.G.I.
250	320	-70	S.G.I.
250	320	-70	S.G.I.
250	318	-68	S.G.I.
950	902	48	Second Grade Classroom
950	919	31	Second Grade Classroom
950	919	31	Second Grade Classroom
950	925	25	Second Grade Classroom
950	925	25	Second Grade Classroom
800	899	-99	Special Education
800	899	-99	Special Education
0	899	-899	Special Education
0	156	-156	Sensory Room
0	156	-156	De-escalation Room
0	899	-899	Overflow Classroom (First)
0	124	-124	Overflow Classroom Storage (Art St)
0	869	-869	Overflow Classroom (Second)
1,100	997	103	STEAM Lab
150	557	-407	ESOL Office
150	558	-408	ESOL Office
150	557	-407	ESOL Office
150	558	-408	ESOL Office
250	0	290	Reading Support
0	0	0	Teacher Support Toilet
0	0	0	Teacher Support Toilet
0	0	0	Teacher Support Toilet
0	0	0	Teacher Support Toilet
100	179	-79	Tech Storage
100	156	-56	Tech Storage
950	929	21	Third Grade Classroom
950	929	21	Third Grade Classroom
950	935	15	Third Grade Classroom
950	935	15	Third Grade Classroom
950	940	10	Third Grade Classroom

Program/Design Comparison

Administration Space			
Ed Spec	Option 5	Option 5	Proposed
Net SF	Net SF	Delta	Room Use
150	150	0	Assistant Principal
300	299	1	Conference
200	198	2	Parent Resource Center
0	428	-428	Passage
180	180	0	Principal
125	126	-1	Records Storage
500	497	3	Staff Break Room
200	200	0	Student Services Conference
0	70	-70	Coat / Supply Closets
150	150	0	Assistant Principal
125	123	2	Supplies
50	67	-17	Toilet
50	67	-17	Toilet
400	397	3	Waiting / Reception
200	200	0	Work Room
2,630	3,152	-522	
3,070			

Health Suite Space			
Ed Spec	Option 5	Option 5	Proposed
Net SF	Net SF	Delta	Room Use
100	100	0	Cots
100	100	0	Cots
125	124	1	Exam
100	100	0	Nurse Office
170	172	-2	Nurse Reception
0	135	-135	Passage
40	70	-30	Storage
50	93	-43	TLT
685	894	-209	
895			

Maintenance and Custodial Space			
Ed Spec	Option 5	Option 5	Proposed
Net SF	Net SF	Delta	Room Use
120	121	-1	Custodial Office
300	303	-3	Custodial Storage
500	500	0	Receiving/Storage
920	924	-4	

Media Center Space			
Ed Spec	Option 5	Option 5	Proposed
Net SF	Net SF	Delta	Room Use
2,250	0	2,250	Library Commons
	437	-437	Collaborative Learning (Third)
	450	-450	Collaborative Learning (First)
	394	-394	Collaborative Learning (Second)
	450	-450	Collaborative Learning (Fourth)
	394	-394	Collaborative Learning (Fifth)
700	1,151	-451	Media Center
200	169	31	Equipment Storage
150	150	0	Head End Room (MDF)
250	179	71	Work Room
0	124	-124	Office
3,550	3,898	-348	
3,700			

Performing Arts Space			
Ed Spec	Option 5	Option 5	Proposed
Net SF	Net SF	Delta	Room Use
1,000	1,002	-2	General Music Room
1,000	1,003	-3	Dual Purpose Arts Room
0	153	-153	Dual Purpose Arts Storage
150	153	-3	General Storage
150	203	-53	Instrument Storage
1,000	943	57	Platform
150	150	0	Platform Storage
0	121	-121	Platform Access (Lift or Ramp)
3,450	3,728	-278	
3,570			

Physical Education Space			
Ed Spec	Option 5	Option 5	Proposed
Net SF	Net SF	Delta	Room Use
4,500	4,500	0	Gymnasium
200	101	99	Dept. Office
150	153	-3	Storage
150	116	34	Storage
5,000	4,870	130	

Student Dining and Food Service Space			
Ed Spec	Option 5	Option 5	Proposed
Net SF	Net SF	Delta	Room Use
3,975	3,763	212	Cafeteria/Commons
340	325	15	Chair Storage
750	750	0	Food Prep
400	400	0	Serving Area
200	207	-7	Dry Food Storage
225	227	-2	Freezer & Cooler
150	150	0	Dishwashing
100	101	-1	Office
100	101	-1	Toilet/Locker
6,240	6,024	216	

Visual Arts Space			
Ed Spec	Option 5	Option 5	Proposed
Net SF	Net SF	Delta	Room Use
1,000	996	4	Multi-purpose Studio
100	103	-3	Kiln
200	202	-2	Art Storage
1,300	1,301	-1	



Proposed View of Front Entrance



Proposed View of Classrooms



Questions or Comments?

Prince George's County Public Schools
Cherokee Lane Elementary School



Partners in Progress

Prince George's County Public Schools
Cherokee Lane Elementary School